



## Agenda

**Meeting** Skipton and Ripon Area Planning Committee

**To:** Councillors Nathan Hull (Chair), Andy Brown (Vice-Chair), Barbara Brodigan, Robert Heseltine, David Ireton, David Noland and Andrew Williams.

**Date:** Tuesday, 3 March 2026

**Time:** 1.00 pm

**Venue:** Ripon Town Hall, Market Place, Ripon HG4 1DG

### Business

Members of the public are entitled to attend this meeting as observers for all those items taken in open session. You may be interested in [subscribing to updates](#) about this or any other North Yorkshire Council committee.

Recording is allowed at Council, committee and sub-committee meetings which are open to the public. Please give due regard to the Council's protocol on audio/visual recording and photography at public meetings. We ask that any recording is clearly visible to anyone at the meeting and that it is non-disruptive.

Anyone wishing to record is asked to contact the Democratic Services Officer (details below) prior to the start of the meeting.

#### Contact Details

For enquiries relating to this agenda and meeting please contact:

Name, Vicky Davies

Vicky.davies@northyorks.gov.uk

E-mail: democraticservices.west@northyorks.gov.uk

Tel: 01756 706486

Website: [www.northyorks.gov.uk](http://www.northyorks.gov.uk)

Monday, 23 February 2026

This page is intentionally left blank

**Officer Update Note**  
**Skipton and Ripon Area Planning Committee**  
**3 March 2026**

**Item 4**

<b>APPLICATION NUMBER:</b>	HGT22/03438/FUL MAJ	<b>PARISH:</b>	Masham
<b>APPLICANT:</b>	Loxley Homes (Masham) Ltd, Trustees of the Swinton Heirs' Trust, Trustees of William's Fund, Broadacres Housing Association, Mulberry Homes Yorkshire Ltd	<b>VALID DATE:</b> <b>EXPIRY DATE:</b>	27 September 2022 31 March 2026
<b>PROPOSAL:</b>	Erection of 46 dwellings, new vehicular access from Swinton Road, public open space and landscaping with associated foul and surface water drainage infrastructure		
<b>LOCATION:</b>	Fields to the North and South of Swinton Road, Masham, North Yorkshire		
<b>RECOMMENDATION:</b>	To <b>DEFER</b> determination to allow the applicant(s) to consider the Arboricultural response and submit further technical evidence and/or justification for consideration prior to formal determination		

## 1. Consultation Responses

A response from the Council's Arboricultural Officer has been received since the Officer Report was published.

An Arboricultural objection is raised with concerns summarised as:

- Out of date tree survey
- Constraints Plan required, including all aspects of hard infrastructure, flood area and tree constraints
- Potential breaches of Root Protection Areas (RPAs) and/or RPAs not adjusted to reflect realistic rooting areas
- Arboricultural Impact Assessment (AIA) has not assessed or considered impacts of drainage infrastructure to the south
- AIA does not assess level changes across the site – particularly serious in relation to veteran tree (T8) whose RPA and buffer zone are extensive.

The Arboricultural Officer confirms support for the direct loss of trees (T12 and T14) needed to facilitate access into the main development area.

## **2. Officer Report – Change to Recommendation**

RECOMMENDATION: That members are minded to DEFER determination to allow the applicant(s) to consider the Arboricultural response and submit further technical evidence and/or justification for consideration prior to formal determination.

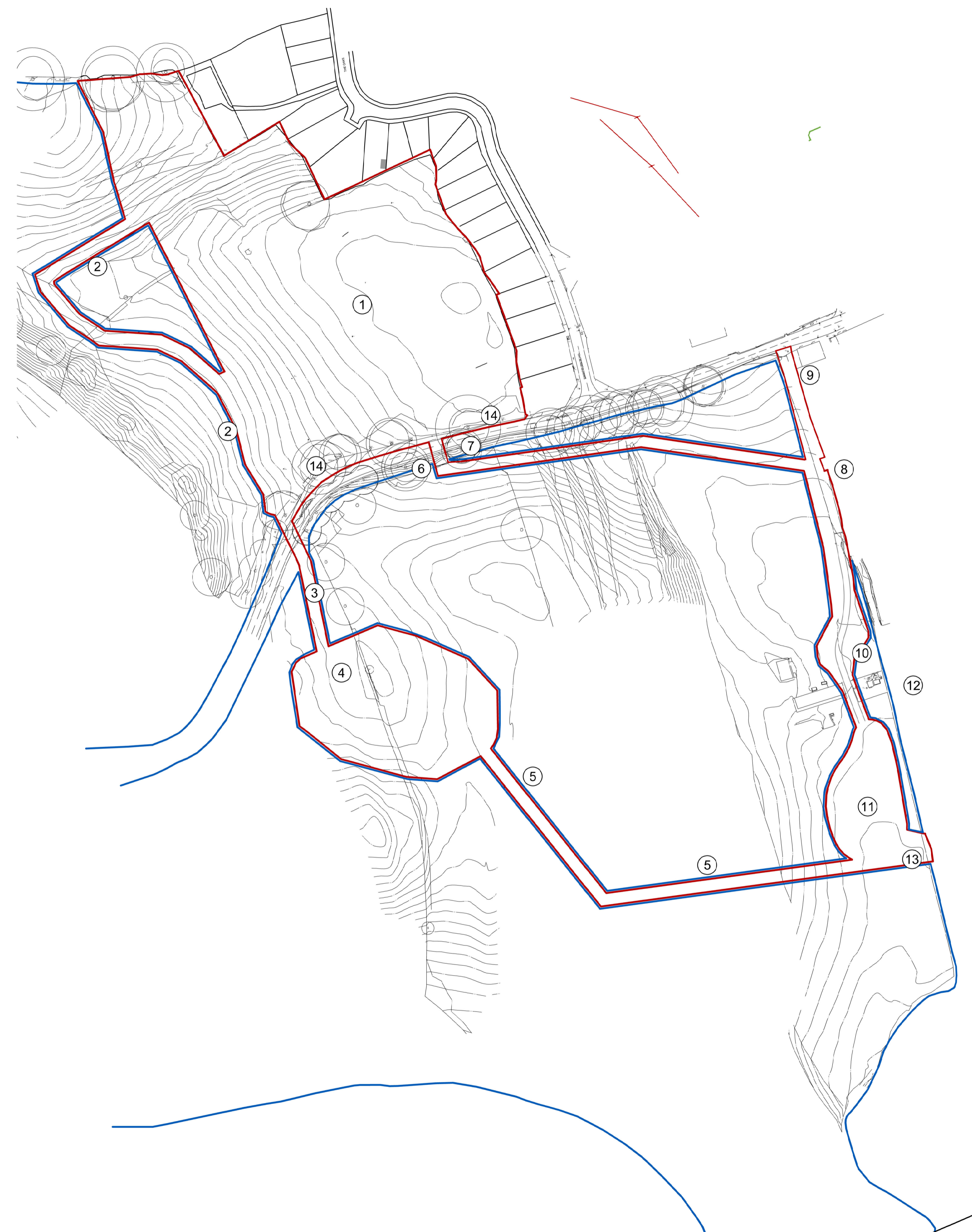
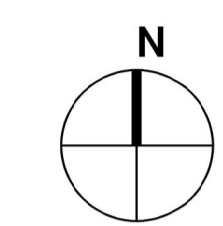

- OTHER LAND OWNED BY THE APPLICANTS
- APPLICATION SITE

Southgate House  
 Pontefract Road T: +44 [0] 1132 008 900  
 Stourton F: +44 [0] 1132 008 901  
 Leeds E: admin@metgeoenvironmental.com  
 West Yorkshire W: www.metgeoenvironmental.com  
 LS10 1SW

Station	Easting	Northing	Level
B1	422104.935	490392.459	89.566
B2	422033.405	490454.867	93.260
B3	422092.141	490400.768	89.786
M1	422104.330	490391.618	89.551
M2	422247.096	490435.493	85.249
M3	422318.483	490453.767	85.216
S1	422096.604	490445.008	88.276
S2	422030.168	490539.613	93.368
S3	422286.921	490364.792	84.658
S4	422355.664	490335.805	83.504
S3X	422330.168	490456.915	84.564
S4X	422208.346	490408.225	87.663

Station	Easting	Northing	Level
M1	422104.330	490391.618	89.551
M2	422247.096	490435.493	85.249
M3	422318.483	490453.767	85.216
S1	422096.604	490445.008	88.276
S2	422030.168	490539.613	93.368
S3	422286.921	490364.792	84.658
S4	422355.664	490335.805	83.504

- SITE NARRATIVE:**
1. MAIN DEVELOPMENT SITE AREA
  2. 1m DEEP CUTOFF DITCH FOR HILLSIDE FLOW DIVERSION.
  3. PROPOSED SW CONNECTION FOR CUTOFF DITCH TO EXISTING FLOODED AREA.
  4. ADDITIONAL FLOOD HOLDING AREA.
  5. PIPED SURFACE WATER DRAINAGE TO WATER COURSE.
  6. PROPOSED FOUL AND SURFACE WATER OUTFALLS FROM DEVELOPMENT SITE.
  7. AREA FOR ELECTRICITY POLE CONNECTION FROM U/G TO EXISTING ABOVE GROUND CABLES.
  8. PROPOSED FOUL MANHOLE CONNECTION TO EXISTING SEWER.
  9. LINE OF EXISTING FOUL SEWER.
  10. EXISTING FIELD ACCESS TRACK UPGRADED AND EXTENDED TO PROVIDE ACCESS FOR Y.W TO HYDROBRAKE.
  11. ADOPTABLE DRY BASIN
  12. EXISTING WATERCOURSE
  13. HYDROBRAKE CONNECTION TO WATERCOURSE.
  14. GENERAL WORKS TO EXISTING TREES AND BOUNDARIES BETWEEN DEVELOPMENT SITE AND ROAD EDGE.

UNLESS STATED OTHERWISE, THE DESIGNS SHOWN ARE SUBJECT TO DETAIL SITE SURVEY AND INVESTIGATIONS AND/OR APPROVAL OF THE RELEVANT VARIOUS LOCAL AUTHORITY OFFICERS, STATUTORY UNDERTAKERS, FIRE OFFICERS AND ENGINEERS. THEY ARE PROJECT AND SITE SPECIFIC.

THIS DRAWING SHOULD NOT BE SCALED FROM.

ALL DIMENSIONS SHOULD BE CHECKED ON SITE.

ANY DRAWING ERRORS OR DISCREPANCIES SHOULD BE REPORTED TO VAUGHAN ARCHITECTURE LTD

THIS DRAWING IS THE COPYRIGHT OF VAUGHAN ARCHITECTURE LTD

<b>DRAWING STATUS</b>			
DRAWN BY:	NJV		
SCALE:	1:1250 @ A1		
DATE:	190921		
H	RED LINE AMENDED FOR DRAINAGE	111125	NJV
T	HOUSING LAYOUT OMITTED	230126	NJV

**A1**

**LOXLEY HOMES - MASHAM - PROPOSED RED LINE**

LEEDS  
LEICESTER  
PONTEFRACT

**Loxley Homes**

**CLIENT** Loxley Homes  
**PROJECT TITLE** LAND NORTH OF SWINTON ROAD MASHAM (SITE MB)  
**DRAWING TITLE** PROPOSED SITE LOCATION

**PROJECT NO.** VAD.20.41  
**DRAWING NO.** PL205  
**REVISION** 1

**VAUGHAN ARCHITECTURE**

Leeds Office | No 2 | Infirmary Street | Leeds | LS1 2JP | 0113 493 1055  
 Leicester Office | Rurland House | 23-25 Friar Lane | Leicester | LE1 5QQ | 0116 326 8905  
 Pontefract Office | Pomfret Business Centre | 2 Harropwell Lane | Pontefract | WF8 1QY | 0113 493 1055

office@vaughanarchitecture.co.uk | www.vaughanarchitecture.co.uk

This page is intentionally left blank