

1RWHV

7KLV 'UDZLOJ LV DQ LQVWUXPHQW RI WKH SURSUJUDJLQJ SURSHUW\ 3DUWQHUVY PDI QRW EH UHSURXFXHG RU FRSLHG XVHG IRU WKH FROVWUXFWLRO HQOO EXLOGLOJ RU DUHD RWKHU WKDO WK DXWKRULVDOVLRQ RI WKH LVXLQJ RI &RQWDFWRUV VKDOO YHULLI DQG E GLPHQLVLRQV DQG FROGLWLRQV DQG GLVWUXODQFH WR WKH LVXLQJ RI DQI ZRUN 'UDZLOJVKDOO QRW EH

3\$9,1* 7<3(\$ 3\$5.,1* \$1' 52\$' 685)\$&,1*
3\$5.,1* %\$<6 '(),1(' :7+ /, '+7(5 &2/285(' %/2&.

*5\$1,7(\$**5,*\$7(3\$9,1* \$1' 7(:785('
(.5%6 7<3(% 3('675,\$1 \$5\$6

%/\$&. &2/285 0(7\$/ 675((7 3/\$17(56

67</(2) 648\$5(%/\$&. &2/285(' 0(7\$/ %2//5\$'6

3/\$1 6<0%2/ +\$7&+ .	*5(< +\$7&+(' \$5(\$ 2) 7<3 \$ 3\$9(' \$5(\$ 5(//9(// \$1' 5(8/\$5,6(' (6,'1(' 72 :7+67\$1' +(\$9< 9(+,88/\$5 75\$)),&
3\$5.,1* %\$<6 '()0\$5.(' : ; /,'+7(5 &2/285(' 3\$9(5 %/2&.6	<(/2: +\$7&+(' \$5(\$ 2) 7< % 3\$9(' \$5(\$ 6,'1(') 3((67\$,\$1 \$&&66 \$5(\$6 :+(5(//9(//6 \$5(%8./7 88 0((7 %8,/'1' //9(// \$&&(6 \$1' &21&5(7())(&7 .5%
1(: (9(5'5((1 75((6+58%/2&\$7,216 63(8,(%(\$5(' ,1 /\$5(' 75((3/\$17,1' 675((7) 851,785 &217\$,1(56	1(: (9(5'5((1 75((6+58%/2&\$7,216 63(8,(%(\$5(' ,1 /\$5(' 75((3/\$17,1' 675((7) 851,785 &217\$,1(56
%/\$&. &2/285(' 0(7\$/ %2//5\$'6 :7+ &2/285 %\$ 0(7(5 7\$//	%/\$&. &2/285(' 0(7\$/ %2//5\$'6 :7+ &2/285 %\$ 0(7(5 7\$//
1(: *57(' 7+5(6+2/ ' \$5,1 \$7 //9(// \$&&(66 72 %8./, 8217\$,1(56	1(: *57(' 7+5(6+2/ ' \$5,1 \$7 //9(// \$&&(66 72 %8./, 8217\$,1(56
1(: %,&<&/(+223 67\$1'6	1(: %,&<&/(+223 67\$1'6
'(127(6 (:67,1' 523 .(59	'(127(6 (:67,1' 523 .(59

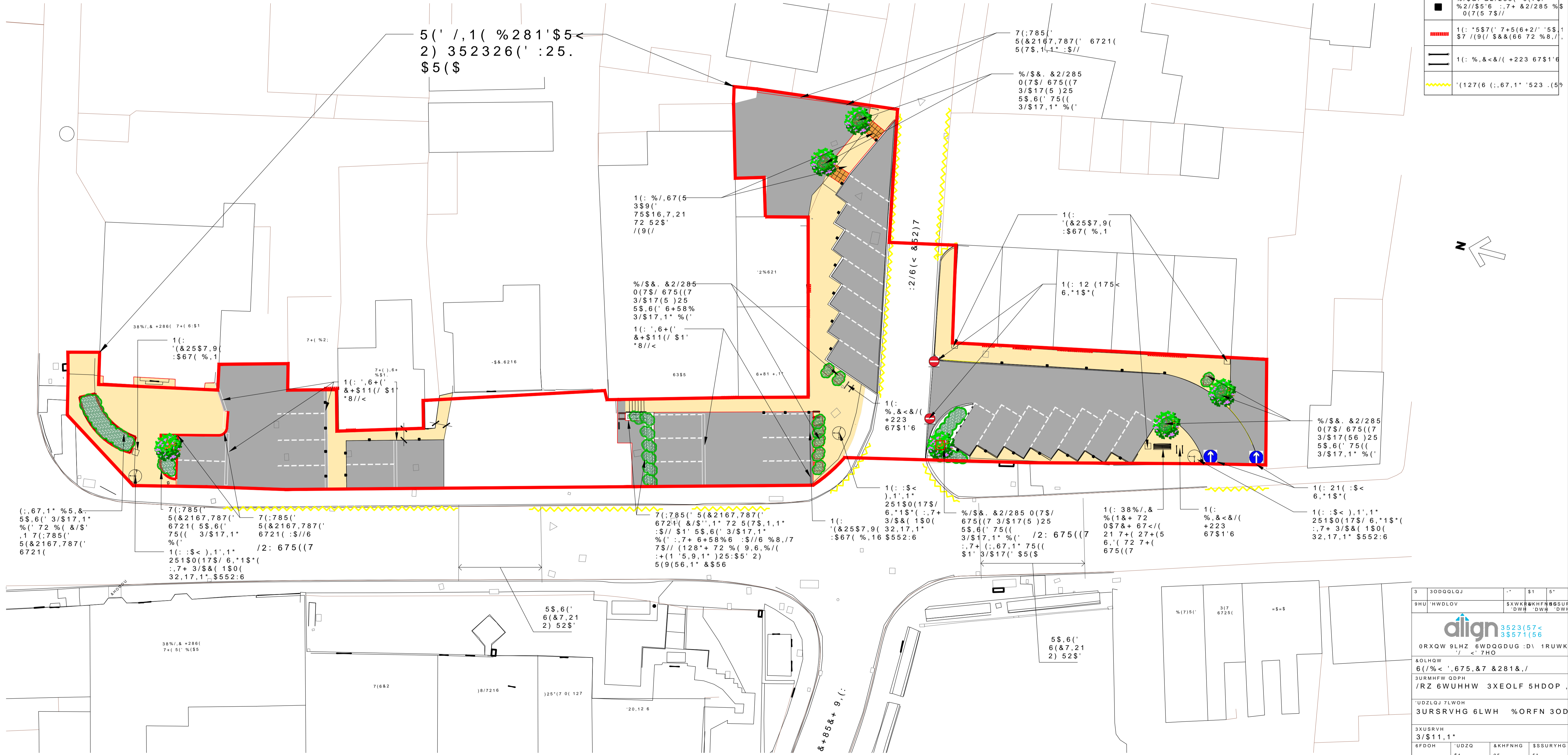

352326(' 6,7(%/2&. &3/\$1

6&\$/(PP

3 30DQGLQJ	'1' \$1	6'
9HU 'HWDOLOV	\$XWKRKHFNHGSUR 'DWH 'DWH	'DWH
align 3523(57< 3\$571(56		
0RXQW 9LHZ 6WDQGDUG :DI 1RUWK '7< 7HO		
AOLHQW 6(/%< '675,&7 &281&/, 3URMHFW ODRP 'JRZ 6WUHHW 3XEOLF 5HDOP		
'UDZLOJ 7LWOH 3URSRVHG 6LWH %ORFN 3OD		
3XUSRWH 3/\$11,1*		
6FDOH	'UDZO \$1	&KHFNHG 05
	SSURYHG 'DWH	'DWH 5'
2ULJLDO 6LQWH		
S		
'UDZLOJ 1XPEHU		
6&	\$33	')' 5 \$
		9HUV 3